



# **Glenoid-Sided Metallic Lateralization**

## **Of Course Glenosphere is Way to Go!**

**Matthew J. Teusink, MD**

**Assistant Professor**

**Department of Orthopaedic Surgery**

**University of Nebraska Medical Center**





# Disclosures

Consultant- DJO Surgical  
Honoraria – Springer SBM



**Feel a little bit like...**



# Why glenoid lateralization?

## *It's Effective at...*

- Minimizes scapular notching
- Improves impingement-free ROM
- Improved rotational strength
- Improves stability

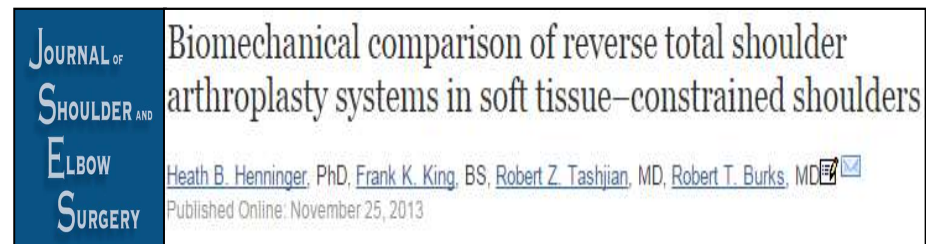

# The Debate

C)

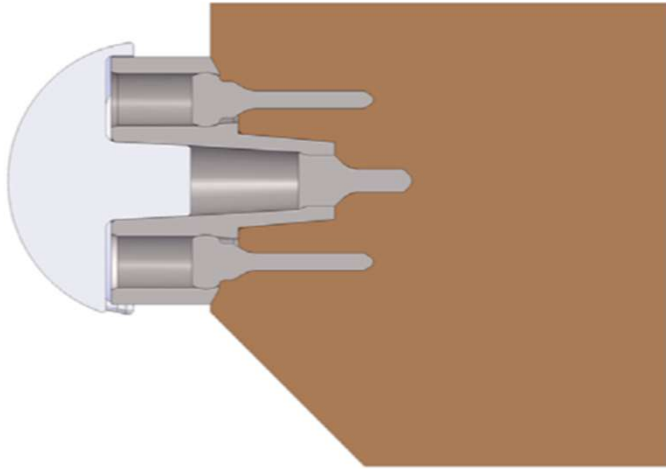

D)

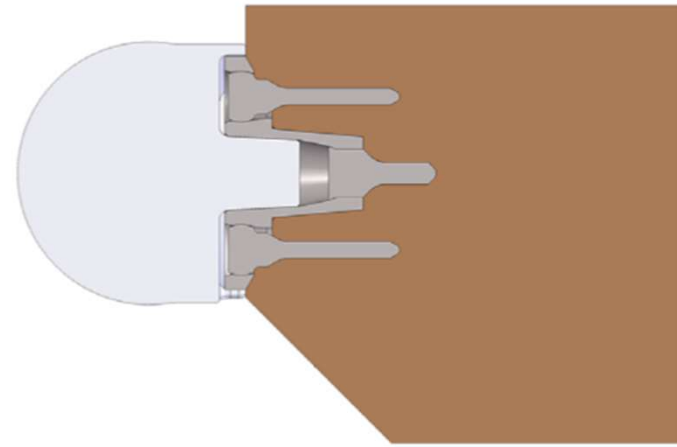

Baseplate Lateralization

Glenosphere Lateralization

## Finite Element Analysis of Glenoid-Sided Lateralization in Reverse Shoulder Arthroplasty

Patrick J. Denard,<sup>1,2</sup> Evan Lederman,<sup>3,4</sup> Bradford O. Parsons,<sup>5</sup> Anthony A. Romeo<sup>6</sup>

<sup>1</sup>Southern Oregon Orthopedics, Medford, Oregon, <sup>2</sup>Department of Orthopaedic and Rehabilitation, Oregon Health and Science University, Portland, Oregon, <sup>3</sup>The Orthopedic Clinic Association, Phoenix, Arizona, <sup>4</sup>Department of Orthopedic Surgery, Banner University Medical Center, Phoenix, Arizona, <sup>5</sup>Leni and Peter W. May Department of Orthopaedic Surgery at the Icahn School of Medicine at Mount Sinai, New York, New York, <sup>6</sup>Rush University Medical Center, Chicago, Illinois

Received 21 March 2016; accepted 9 August 2016

Published online 28 August 2016 in Wiley Online Library (wileyonlinelibrary.com). DOI 10.1002/jor.23394



# Why do I prefer glenosphere?

## *It works!*

- ASES Total  
35 → 74
- Forward Flexion  
70° → 126°
- Abduction  
65° → 117°
- External rotation  
18° → 40°

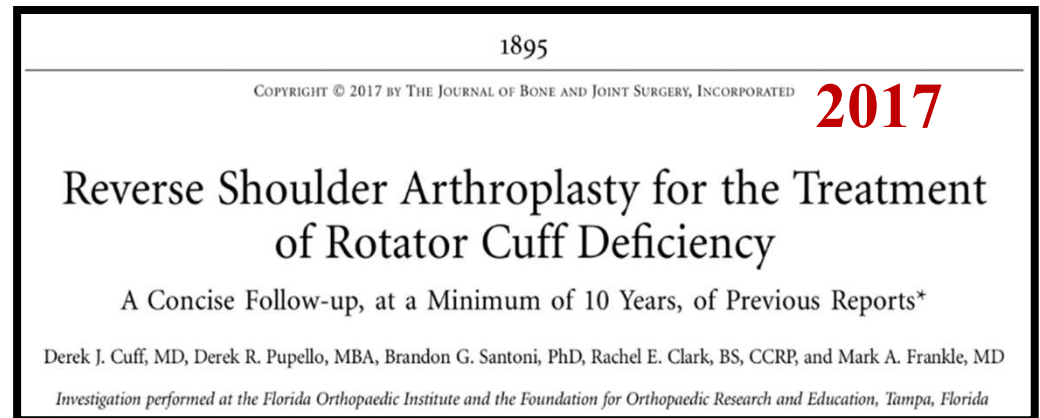
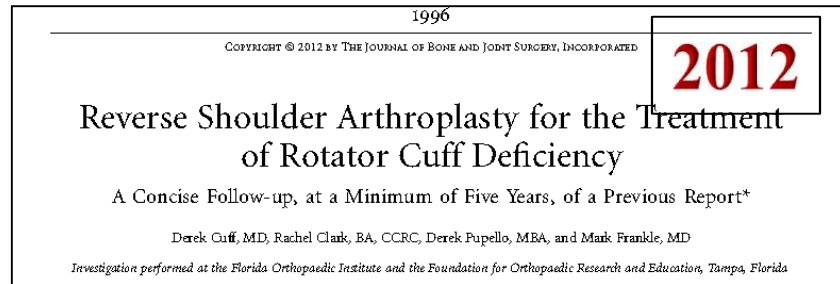

**91% survivorship**



# Why do I prefer the glenosphere?

## *It's Easy*

- 7 size options
- Easy adjustment
- Maintains lateralization

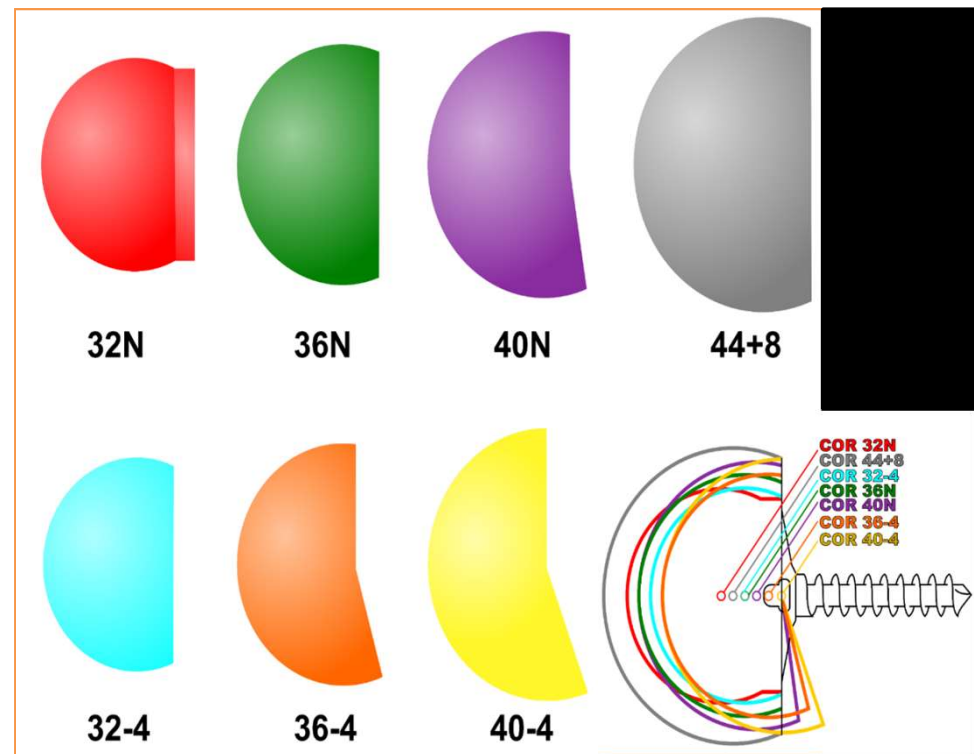

# Why not the glenosphere?



- **Effective**
  - Maintained long-term clinical improvement
  - Excellent long-term survivorship
- **Easy**
  - Place a glenosphere
  - Change it out if not tensioned appropriately--  
DONE

What more could you  
want?



[Summary](#) [Agenda](#) [Faculty](#) [Accreditation](#) [Supported By](#) [Fees](#) [Accommodations](#) [REGISTER NOW!](#) [Contact Us](#) [More Live Courses](#)

26<sup>TH</sup> ANNUAL  
**TAMPA**  
SHOULDER COURSE  
ARTHROPLASTY & SPORTS

Tampa Marriott Waterside Hotel | Tampa, FL  
January 30-February 1, 2020

A wide-angle photograph of the Tampa skyline, featuring several high-rise buildings and a waterfront area with a river or bay. The sky is blue with scattered white clouds.

# Thank you

